

# LINKA BUILDING KIT

# LINKA

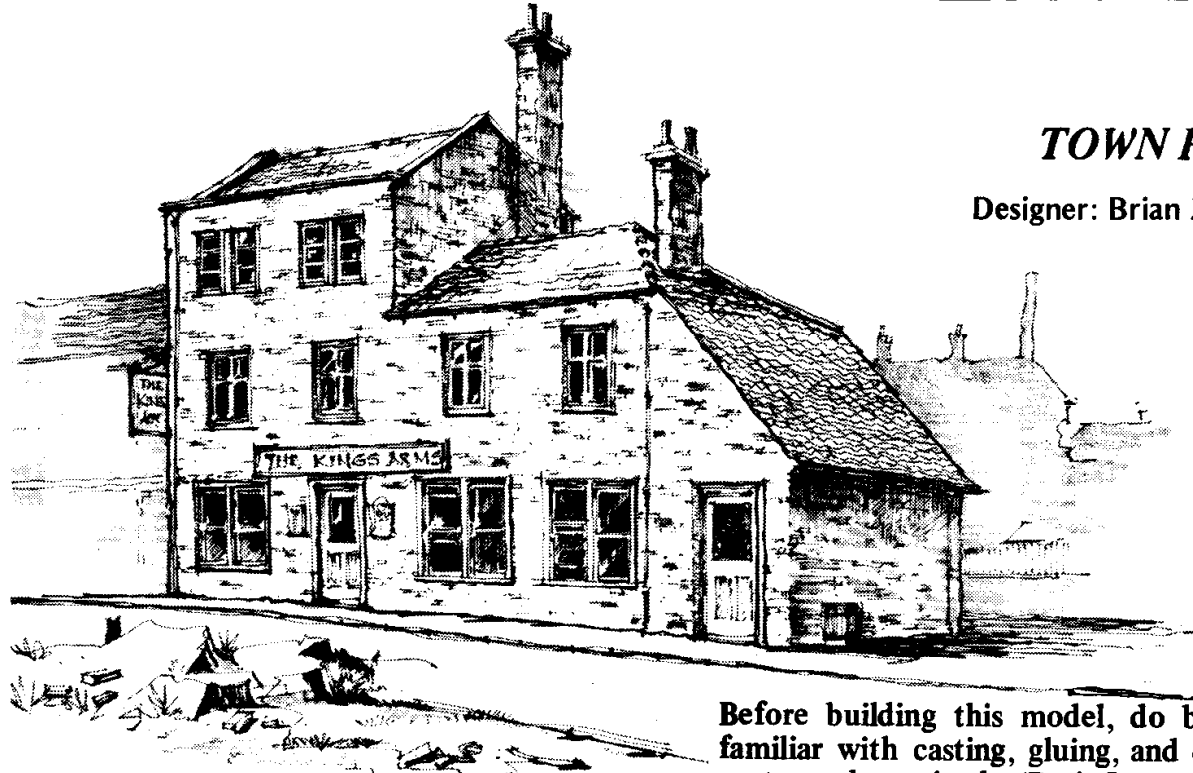

## TOWN PUB

Designer: Brian Zobel

### PARTS NEEDED:

Before building this model, do become familiar with casting, gluing, and cutting parts, as shown in the 'Basic Instructions'.

There are six moulds in this set. Cast each mould as shown below:

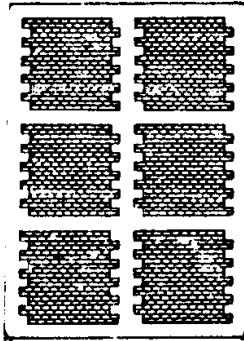

CAST B1  
THREE TIMES

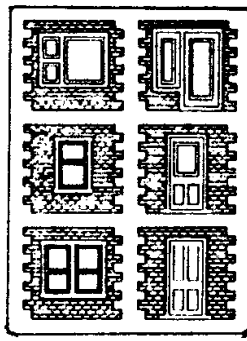

CAST B2  
THREE TIMES

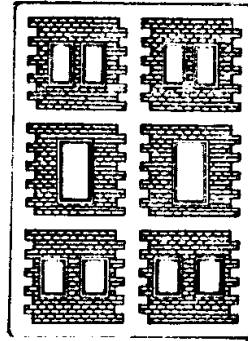

CAST B3  
THREE TIMES

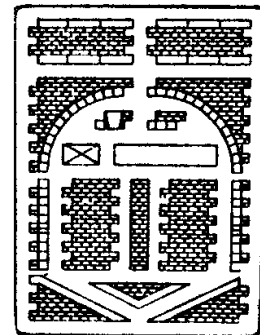

CAST B5  
FIVE TIMES

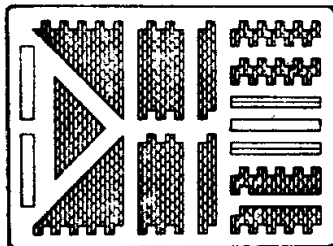

CAST B6 THREE TIMES

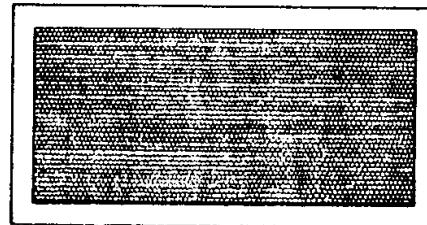

CAST PR2 TWICE

This will produce all the castings needed for this model, as well as a number of spare parts. These spare parts are useful in case you accidentally break any parts during construction, as well as providing extra parts for any variations you may choose to add.

**BUILDING THE GROUND FLOOR:**

1) Using the castings shown below, glue the front wall together, taking care to align joints well before leaving to set.

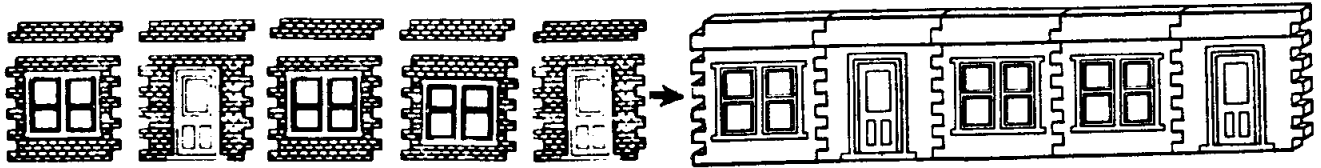

2) Glue the two side walls together. (Cut two B1 panels into strips - five from each panel - to create the extra parts needed to extend the ground floor walls.)

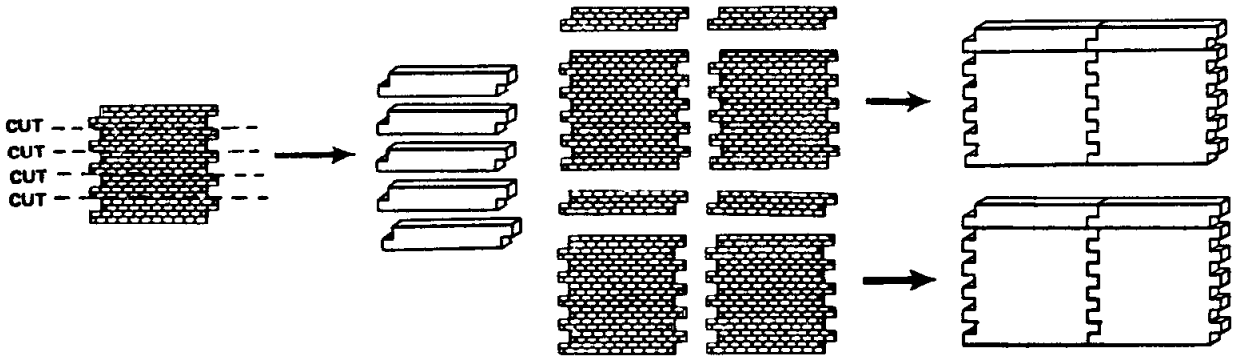

3) Glue the rear wall together, with two parts at right angles to form the rear extension, as shown below.

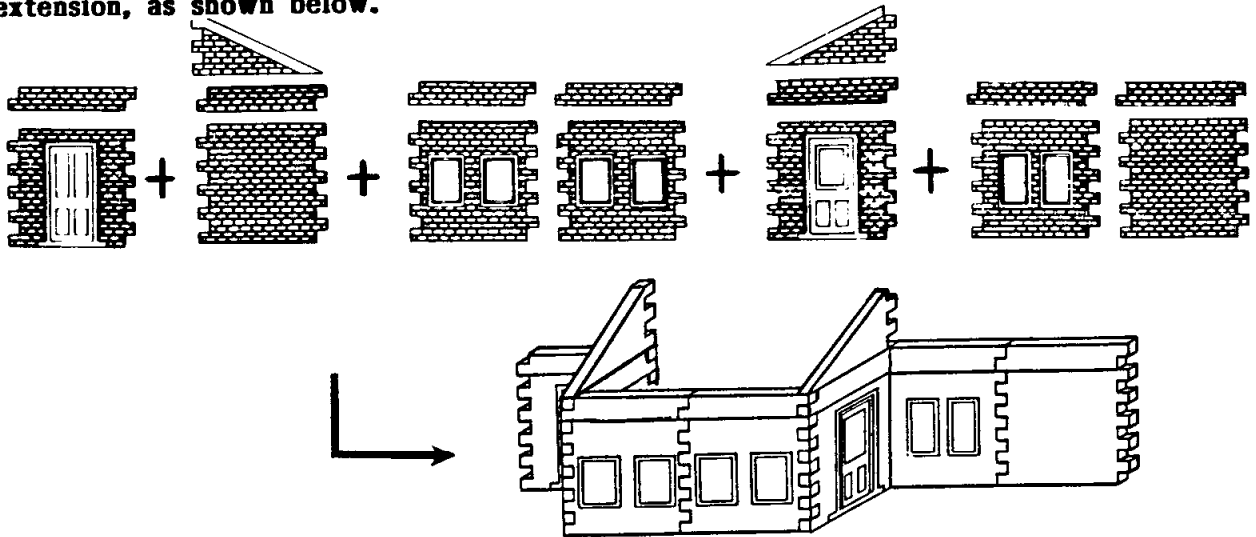

4) When set, carefully glue all four walls together.

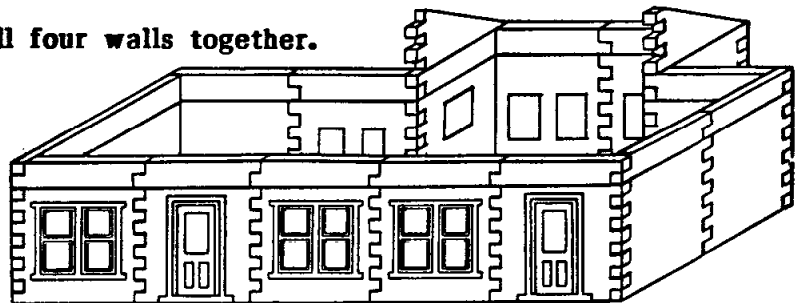

**BUILDING THE FIRST FLOOR:**

1) Using the castings shown below, glue the back wall together.

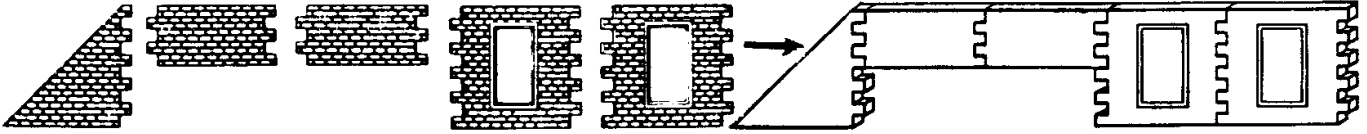

2) When set, glue this back wall in place on top of the ground floor extension, by engaging the inner teeth into the upper part of the ground floor extension, as shown below. Take care to align the two walls well.

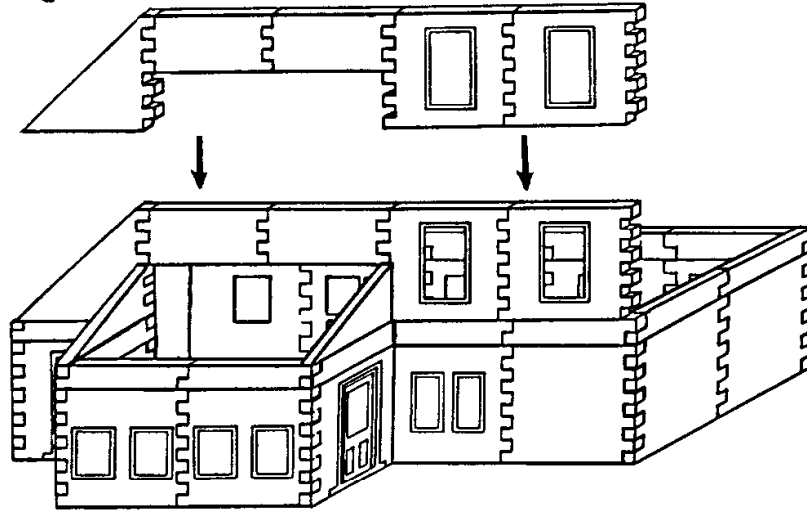

3) Glue the front and side walls together.

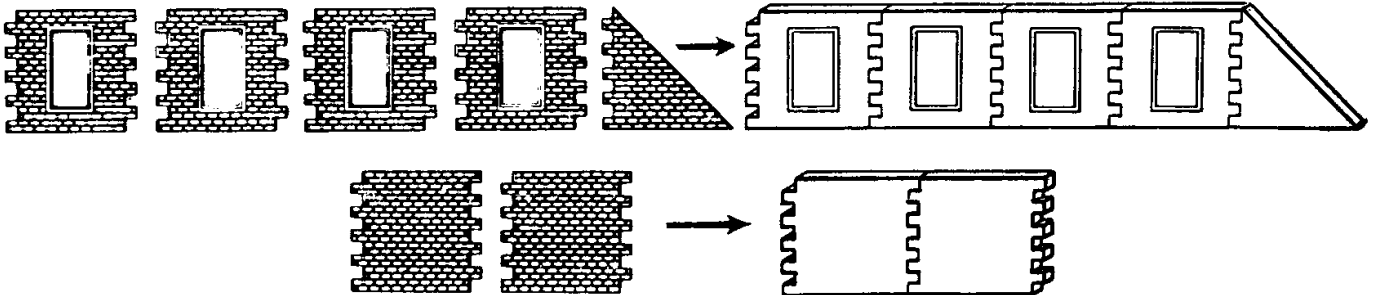

4) Glue the front and side walls in place to complete the first floor, as shown below.

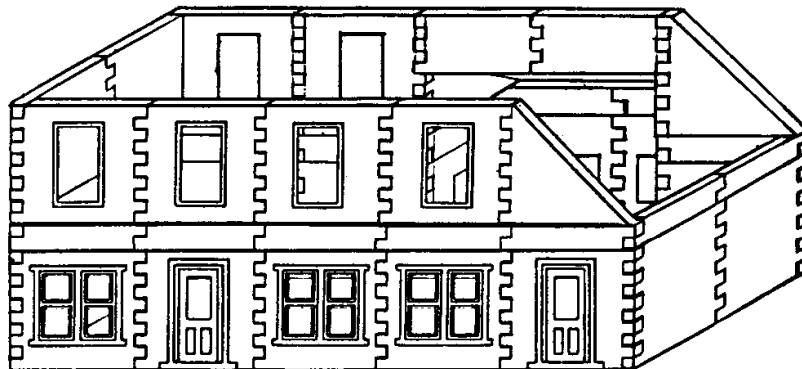

**BUILDING THE SECOND FLOOR:**

1) Glue the front and back walls together.

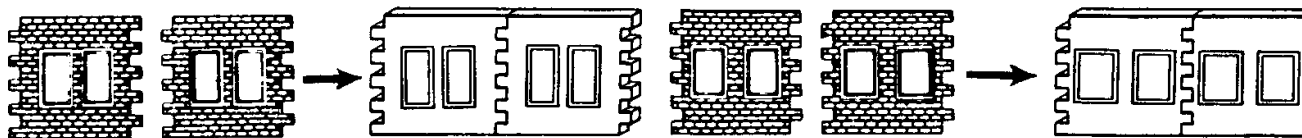

2) Glue the two side walls together.

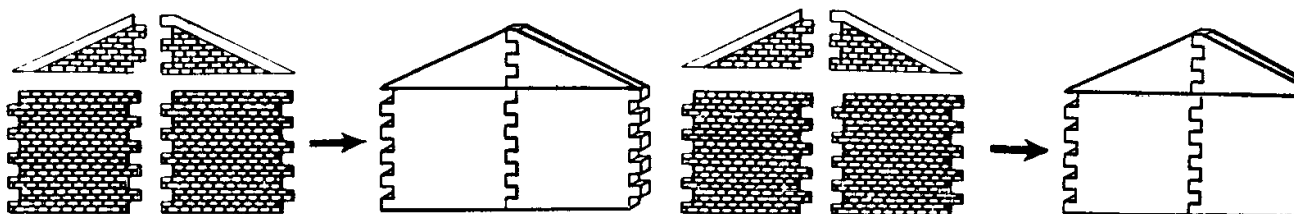

3) When set, glue all four walls into a square; then carefully glue this completed second floor into place on the model and align well, as shown below.

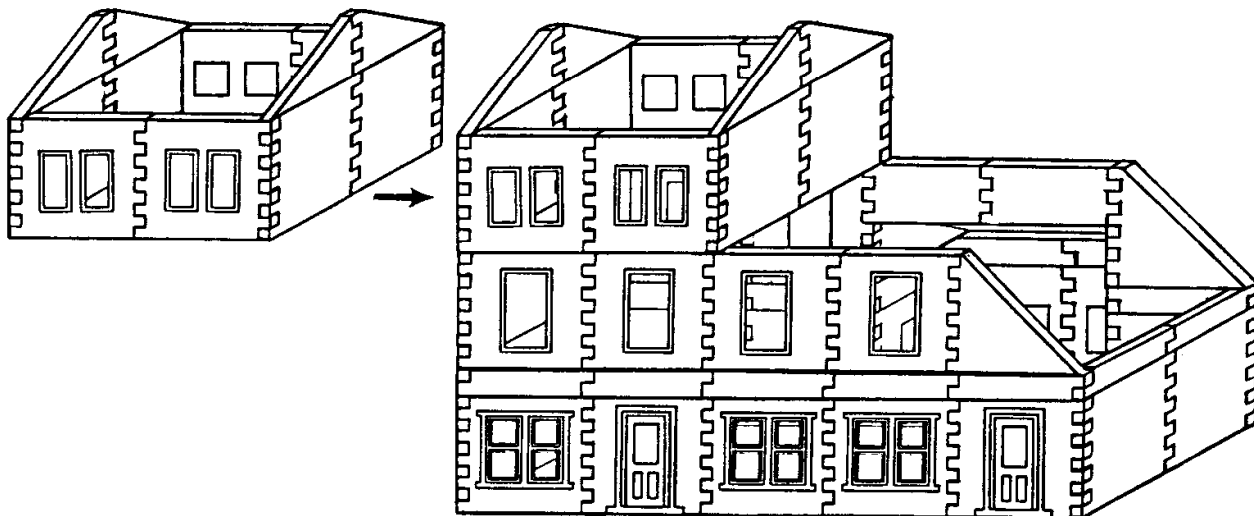
**ADDING THE ROOF:**

1) Glue together the two main roof supports, as shown below. Select the two apex pieces shown below, which act as upper roof supports.

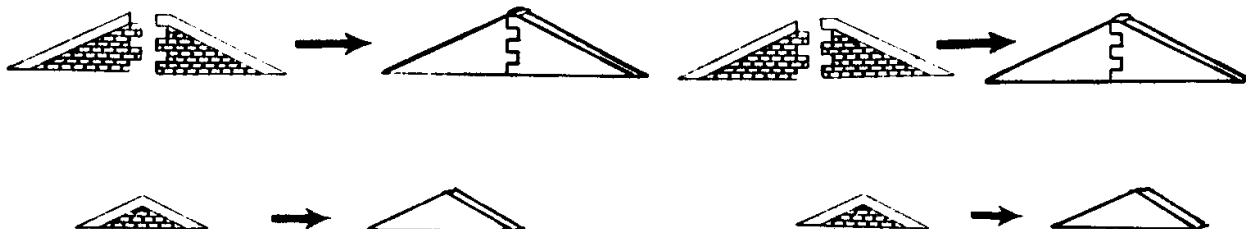

2) When set, glue the roof supports in place on the model, as shown below.



3) Take two PR2 castings, and ink in the cut lines, as shown in the diagrams below. Carefully cut out the six pieces needed.

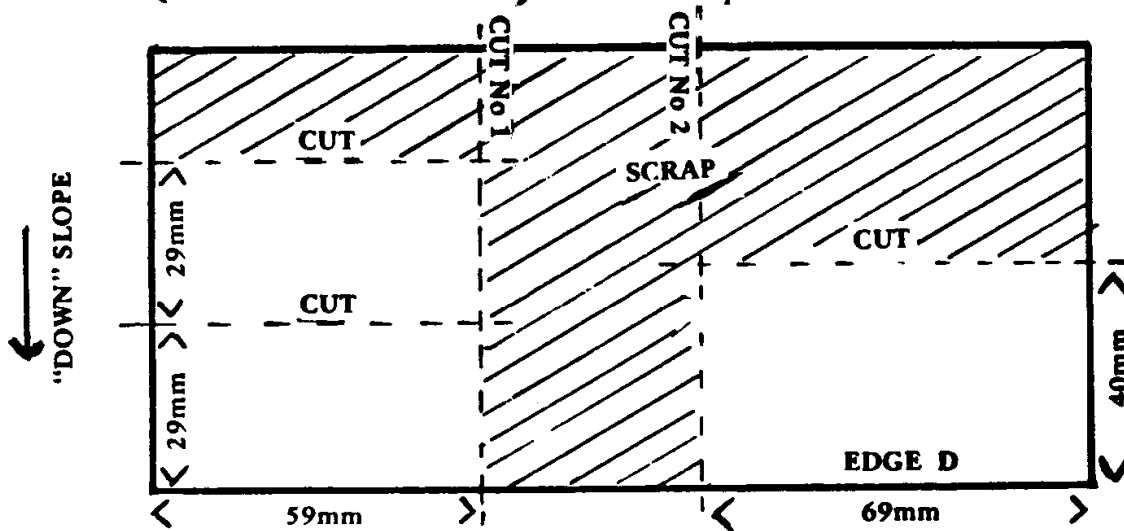
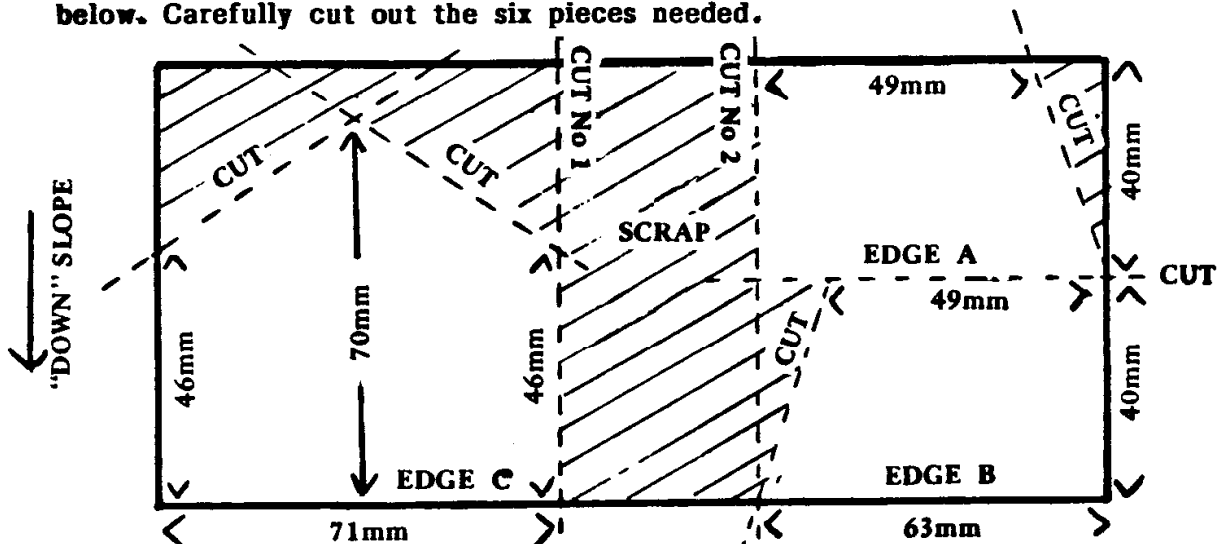

4) The bottom edge of four of the roof parts (edges A,B,C, & D) need to be chamfered to create the correct angle for gluing on the guttering. Place each roof part indicated face down (smooth side up) on a firm surface and sand the bottom edge to an angle, as shown below.

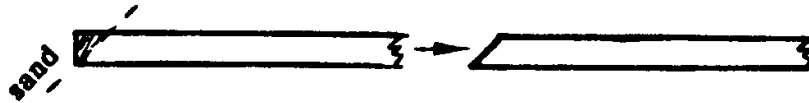

5) Glue the roof parts into place.

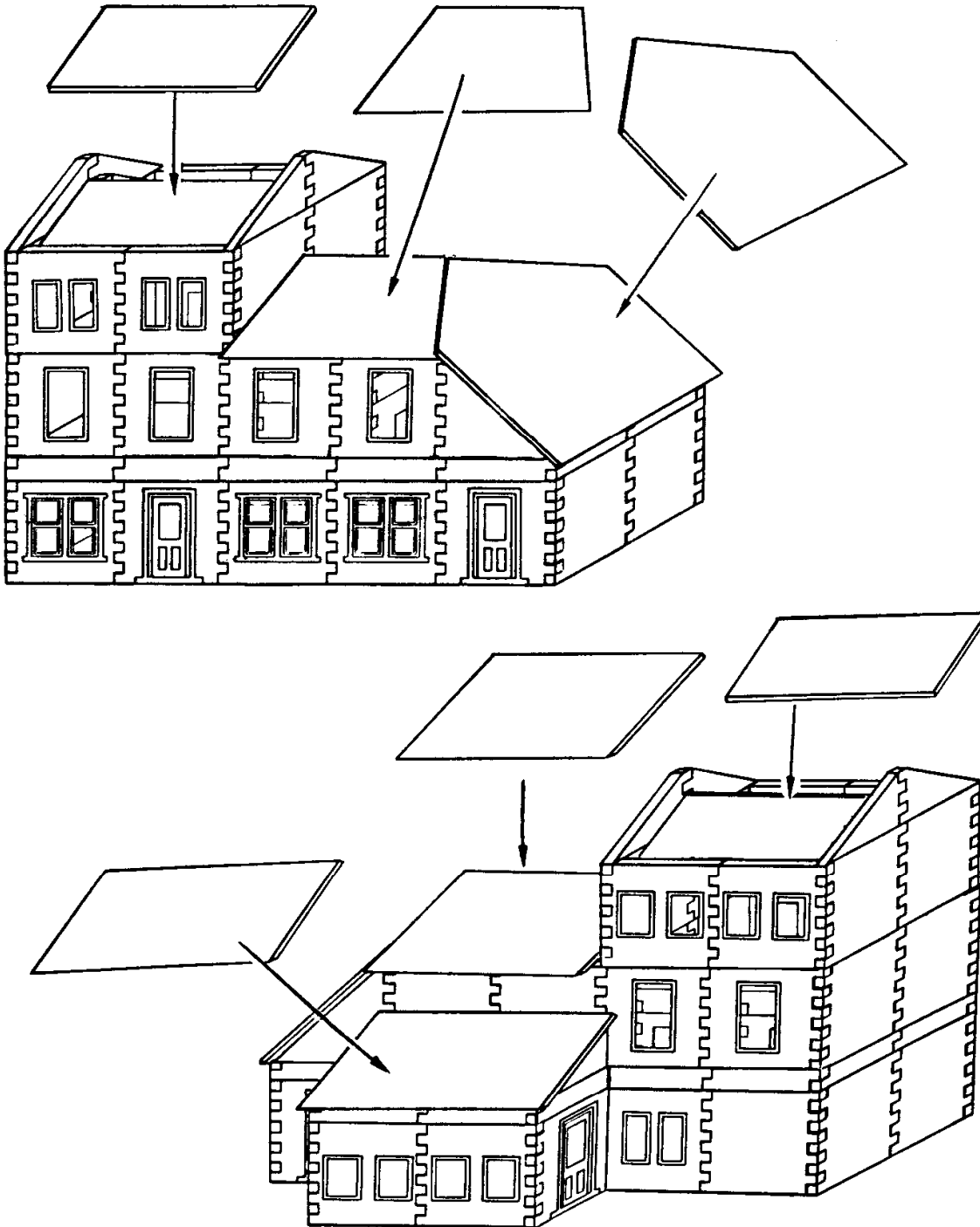

6) Glue the supplied metal ridging in place as shown below, cutting and filing as needed.

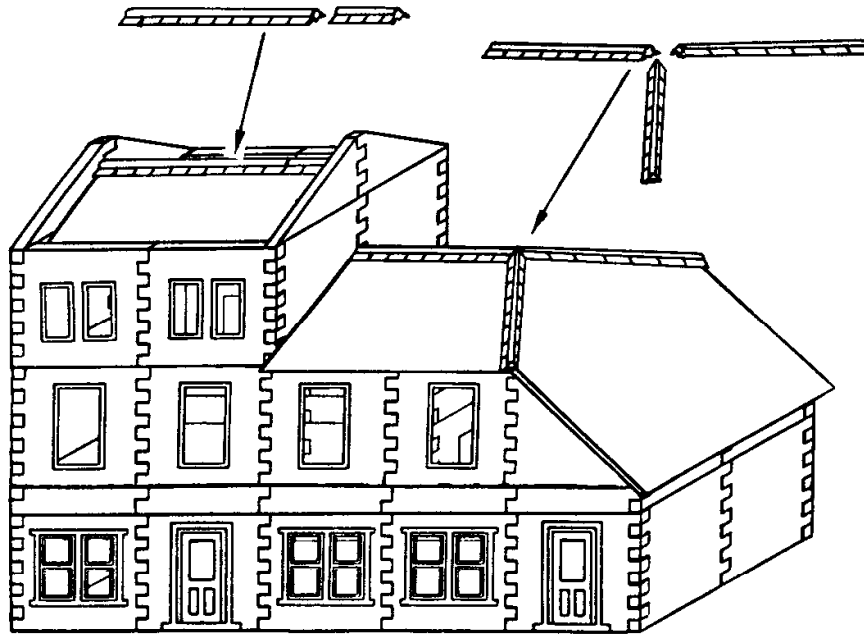

7) Glue the coping (from mould B6) in place on top of the second storey walls.

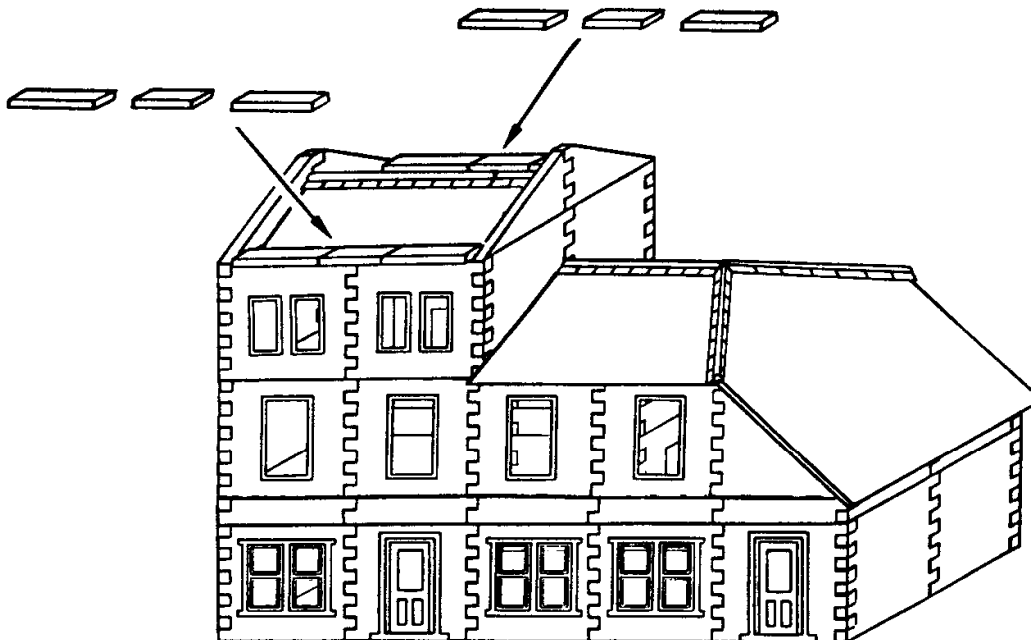

**ADDING THE CHIMNEYS:**

- 1) Using the castings shown below, glue together the long chimney stack. (Don't worry if any of the thin side-castings break as you use them - glue them in place - any fractures will become invisible once the model has been painted.)
- 2) When set, carefully cut the long chimney stack to an angle, as shown below, to fit the middle roof. Score deeply into the castings; then break off the unwanted part, and sand the base of the chimney stack smooth.

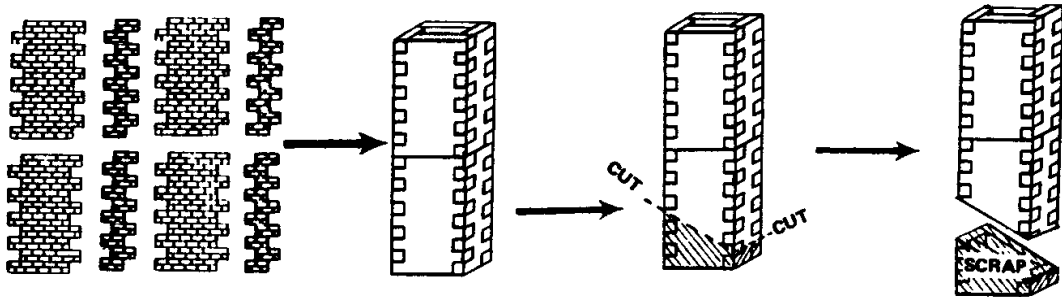

- 3) Glue together the short chimney stack.

- 4) When set, carefully cut the short chimney stack to an angle, as shown below, to fit the end roof.

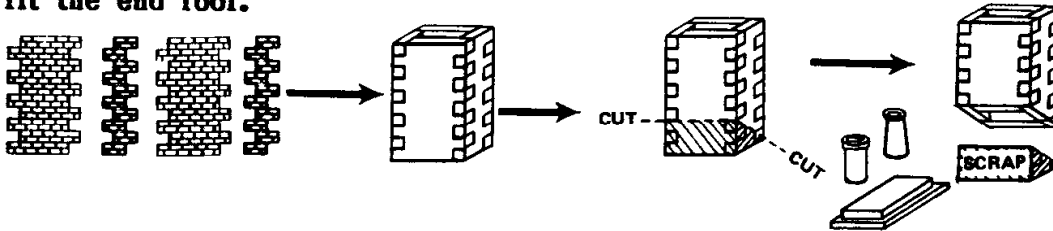

- 5) Glue both chimney stacks in place. Glue both chimney stack tops (supplied complete) in place; then glue the chimney pots on top.

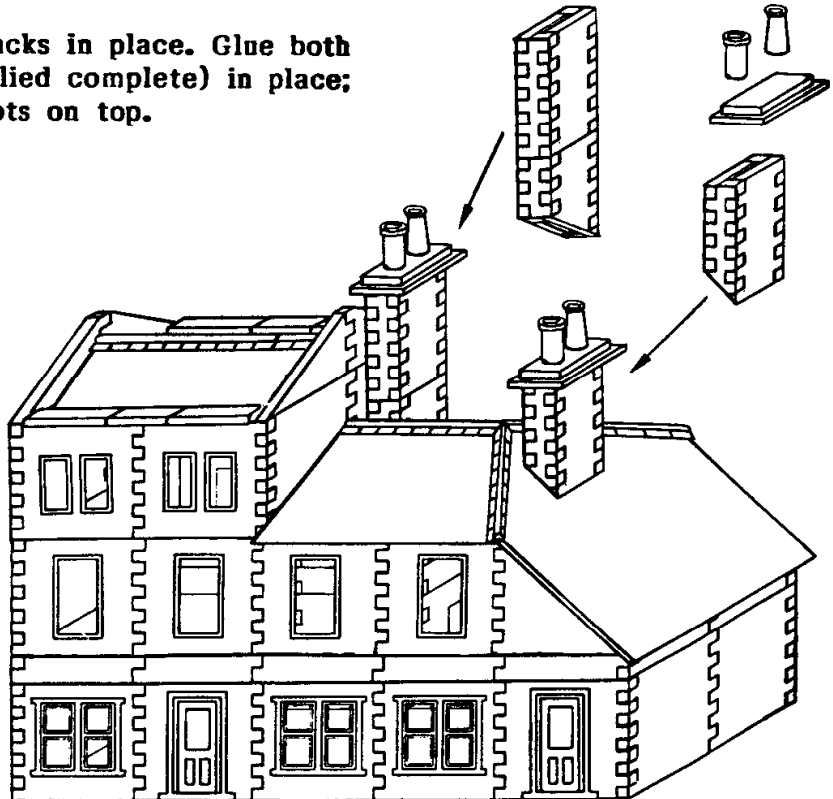



### PAINTING & FITTING WINDOWS:

The model is now ready for painting. Many model paints can be used for painting Linka models, with pots of enamel or acrylic paints (such as "Humbrol", available from most model and craft stores) being popular. For brick and stonework, etc., use a matt paint; for doors, window frames, gutters, drainpipes, etc., use a gloss paint.

You should find the painting both interesting and straightforward, as the castings take paint well, with the crisp detail helping to guide your brush.

The exact shades and colours to be used are up to you, as brick and tile vary greatly in hue. You may find it helpful to refer to the coloured illustration on the box. A colour guide is also included in this kit.

1) Paint all brickwork with your chosen brick colour, then all roofing with your chosen tile colour. Paint the chimney stack tops and the coping on top of the second storey with a stone colour.

2) Once this first coat of paint is dry, check the model for any gaps or ill fitting joints. Fill any gaps by making a very weak mix of Linka moulding compound (about  $\frac{1}{2}$  teaspoon of compound to 3 teaspoons of water) and paint this mix into the gaps with a small paintbrush. An old toothbrush is useful for cleaning off any excess mix, as well as for cleaning out any detail that may have been inadvertently covered. Repaint with brick or tile colour as needed.

3) Glue the supplied plastic window frames into their appropriate window spaces, as shown below.



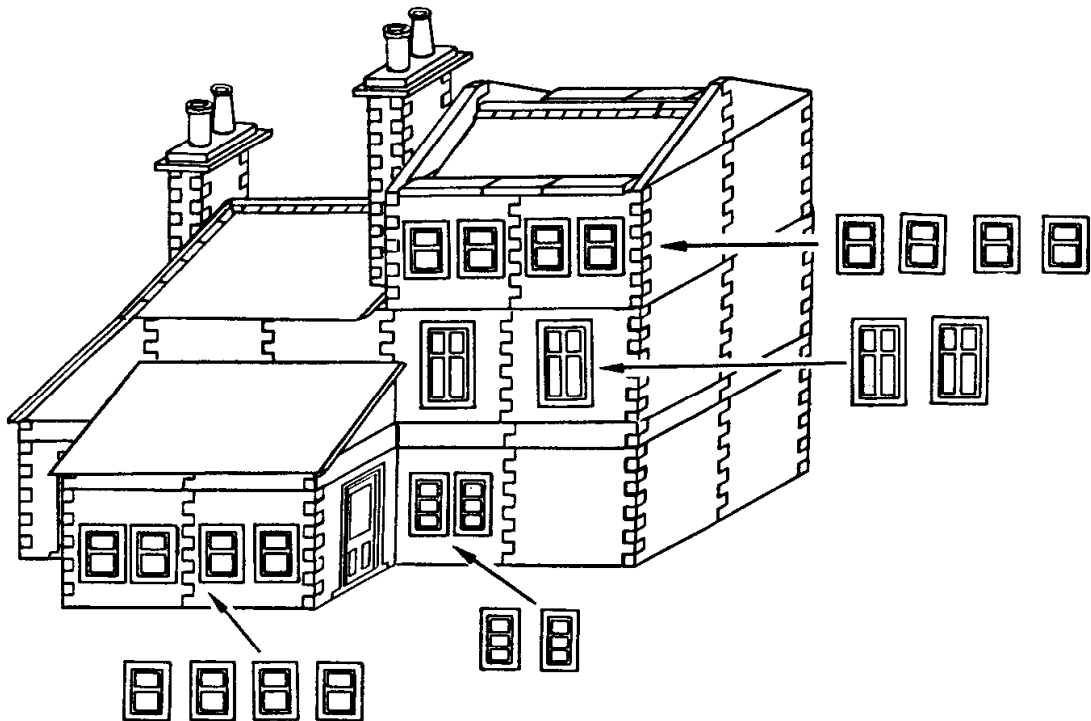

4) Decide on your colour scheme and, using gloss paint, paint the doors and the outer frames of the plastic windows the colour chosen. Paint the non-plastic window frames gloss white. Paint the chimney pots matt orange.

5) For greater realism, pick out various bricks in different shades of brick colour: mix a little palette of brick colour, then add small dabs of red or yellow to give different shades of brick. This can be applied at random to various bricks around the model. Do this two or three times with different shades. Repeat the process with varying shades of tile colour on the roof.

6) When all the paint is dry, cut out and glue the supplied clear plastic sheet behind each set of windows, inside the model. Little strips of tissue paper can also be added to give the effect of net curtains.

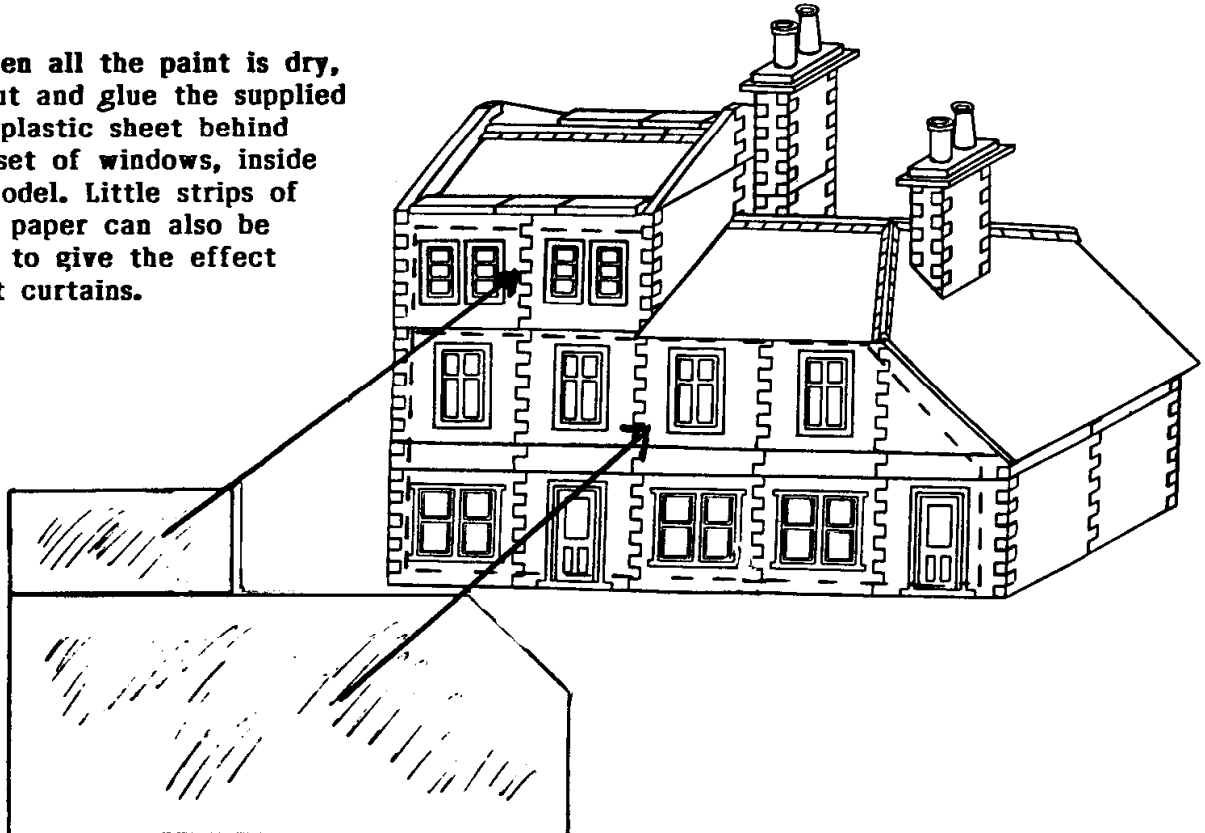

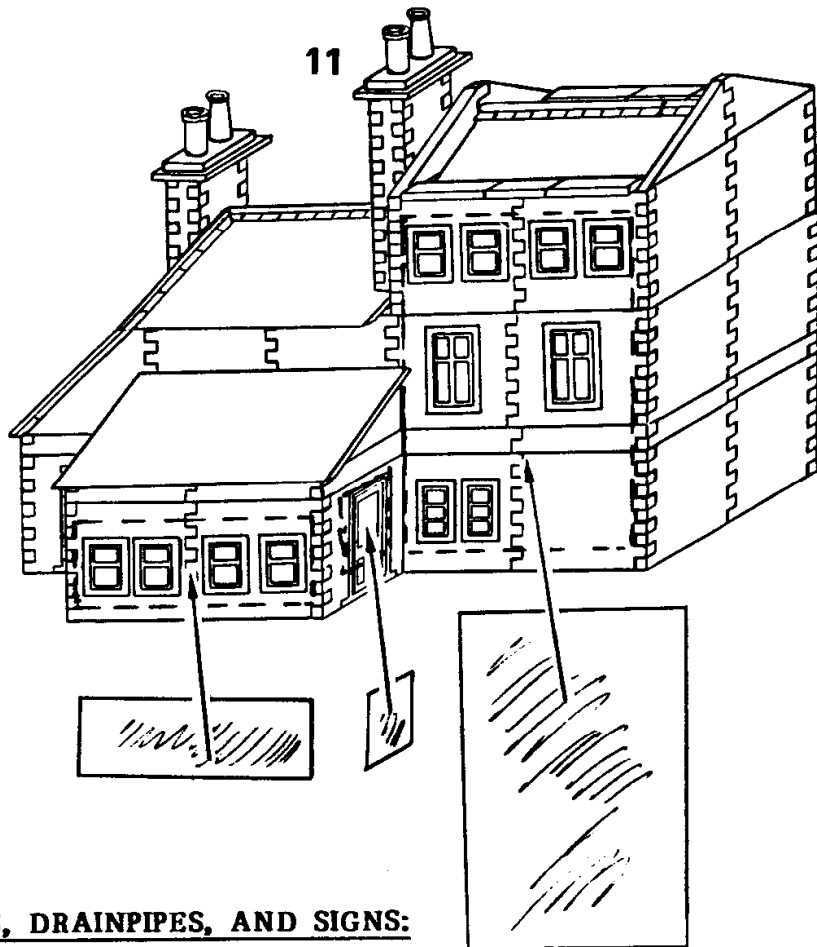

**ADDING GUTTERS, DRAINPIPES, AND SIGNS:**

- 1) Cut four pieces of plastic guttering to length and glue in place under the eaves of the middle, rear, and side roofs, as shown below.
- 2) Cut five pieces of plastic drainpipe to length and glue in place, as shown below; then glue the two supplied rain hoppers to the top of each long drainpipe.
- 3) Paint the metal signboard and hanging sign to match the doors. When dry, cut out the appropriate pub names from the sheet provided and glue in place on the signboards. Glue the completed signboards in place, as shown in the illustration on the next page.



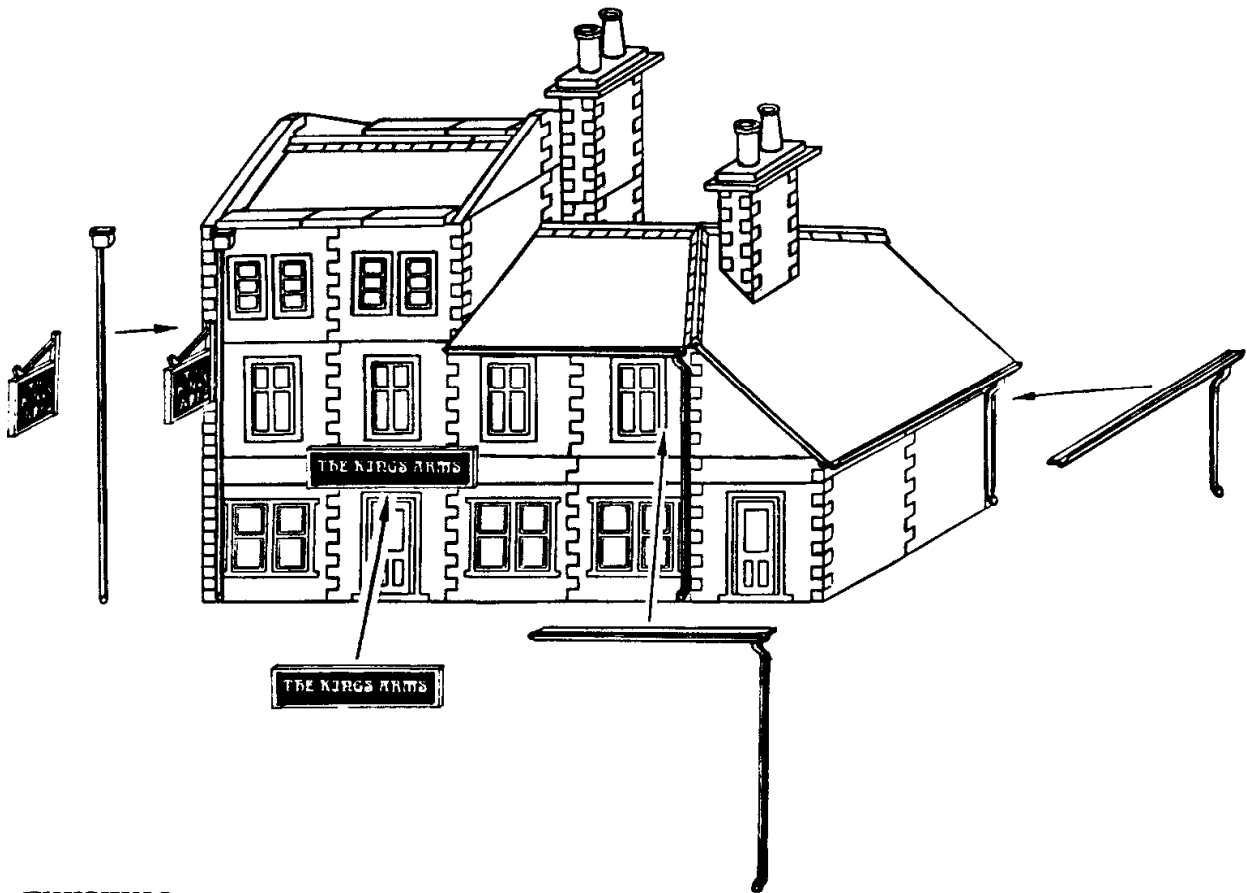

### FINISHING:

For the final finishing and weathering of the model, switch to watercolour paint, in either powder, tube or block form. With a well diluted mix of white watercolour, paint the entire brickwork area; when dry, some of the paint will have collected in the mortar runs to represent cement. If it has coloured the brickwork too much, sponge off the excess. Repeat with a black wash for the roof. This process can be repeated for heavier weathering effects, or washed off and re-applied for any change of effect.

### MAKING A STREET SCENE:

You can use the moulds in this set to make other models. Additional sets and moulds are available for extending your collection. Moulds are also available for pavements and other effects, such as cobbles and patios, so that a little beer garden could be created around your model pub, or a whole street scene could be built - see the spares' order form for the full range.

### THE WORLD OF LINKA

We hope you have enjoyed this kit. It is one of a large and varied range available, with many fascinating accessories and features - build up a collection with this absorbing hobby.